



**C.R.I. PUMPS**  
Pumping trust. Worldwide.

# VERTICAL MULTISTAGE CENTRIFUGAL PUMPS



**MTP / MTC / MVC  
SERIES**

# VERTICAL MULTISTAGE CENTRIFUGAL PUMPS

## MTP / MTC / MVC SERIES

C.R.I. Multistage Vertical pumps are powered by a Totally Enclosed Fan Cooled, A.C. induction motor, suitable for continuous duty. Motor stator is made of low watt loss steel laminations assembled under pressure and rigidly locked in the frame. Dynamically balanced rotor ensures vibration and noise free operations. The varnished impregnated windings made of enamelled copper wire offer excellent resistance.

### SALIENT FEATURES

- Corrosion resistant Stainless Steel grade pump parts ensures longer life.
- All single phase motors are fitted with thermal motor protectors
- Heavy type seal is used for high with standing capacity
- ED coated premium grade SG casting components used for high durability
- Enhanced hydraulic efficiency
- Good compatibility and environment friendly
- Low noise level and low vibration level

\*Cartridge seals will be supplied for specific models

### APPLICATIONS

- Pressure Boosting Systems in High rise buildings, hotels, Industries, etc.,
- Reverse Osmosis Systems & Ultra Filtration Systems
- Modern irrigations such as Sprinklers, Drip feeds etc.,
- Hot & Cold water circulation
- Waste water disposal, dyeing and washings

## MTP SERIES



### SPECIFICATIONS

Power Range	: 0.55 kW - 2.2 kW (0.75 HP - 3 HP)
Head Range in Meters	: 25 Mtrs to 211 Mtrs
Flow Range in Meters	: 1 m <sup>3</sup> /hr to 4 m <sup>3</sup> /hr
Version	: Single Phase, 230V & Three Phase 380V-415, 50Hz, A.C. Supply
Liquid Temperature	: 0° C to 90° C
Ambient Temperature	: 45° C
Max. Working Pressure	: 21 bar
Insulation Class F	: "F"
Degree of Protection	: IP 55

### MATERIAL OF CONSTRUCTION

Pump Shell	: SS 304	Motor Frame	: Aluminium
Impeller	: SS 304 / Noryl	Front & Back Cover	: Aluminium
Diffuser	: Noryl	Cooling Fan Cover	: Mild Steel
Mech. Seal	: SiC vs Carbon vs Viton	Cooling Fan	: Nylon

## DIMENSION

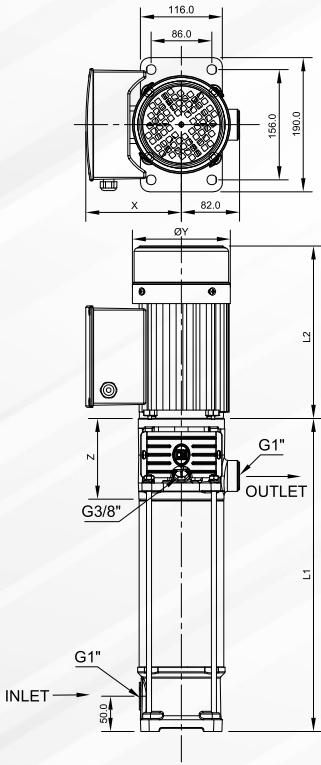

Model	Power		Dimension in mm							Weight in kg		
	kW	HP	L1	L2		X		ØY	Z	Pump		Motor
				1Ph	3Ph	1Ph	3Ph			MTP	1Ph	3Ph
MTP-2E/06	0.55	0.75	370	240	240	148	112	139	114.5	8.0	8.2	7.8
MTP-2E/08	0.75	1.0	411	240	240	148	112	139	114.5	8.2	9.5	9.0
MTP-2E/10	1.1	1.5	452	260	260	148	112	139	114.5	8.5	10.7	10.4
MTP-2E/12	1.1	1.5	493	260	260	148	112	139	114.5	8.8	10.7	10.4
MTP-2E/14	1.5	2	556	320	290	157	121	160	132.5	9.5	15.3	12.0
MTP-2E/16	1.5	2	597	320	290	157	121	160	132.5	9.8	15.3	12.0
MTP-2E/19	2.2	3	658	303	303	161	125	176	132.5	10.2	18.0	16.7
MTP-2E/22	2.2	3	720	303	303	161	125	176	132.5	10.6	18.0	16.7

## PERFORMANCE CHART

MODEL	kW	HP	m <sup>3</sup> /hr	0	1	1.5	2	2.5	3	3.5	4
				0	0.27	0.41	0.55	0.69	0.83	0.97	1.11
MTP-2E/06	0.55	0.75	HEAD IN METRES	49	44.5	42	40	36.5	33.5	30	25
MTP-2E/08	0.75	1.0		67	62	58.5	55	52	47	41.5	35
MTP-2E/10	1.1	1.5		86	80	76.5	70	62	52.5	45	37
MTP-2E/12	1.1	1.5		104	85.5	90	83	73.5	62.5	50	37.5
MTP-2E/14	1.5	2		127	117	109	100	87.5	72.5	57.5	42
MTP-2E/16	1.5	2		145	130	122.5	112.5	100	85	67.5	47.5
MTP-2E/19	2.2	3		179	163	153.5	141	126	108	88	63
MTP-2E/22	2.2	3		211	182	180	165	150	127.5	100	70

**PERFORMANCE CURVE**

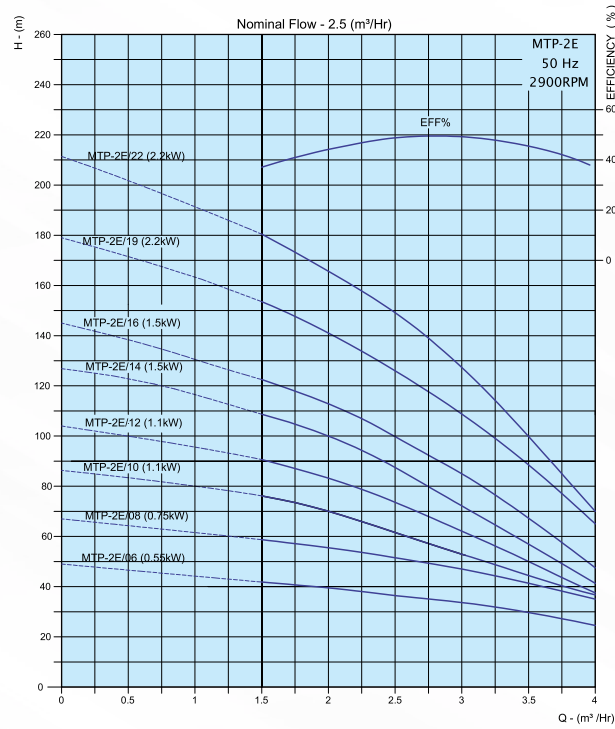

**MTC SERIES**



**SPECIFICATIONS**

- Power Range : 1.1 kW to 3 kW (1.5 HP to 4 HP)
- Head Range in Meters : 37 Mtrs to 211 Mtrs
- Flow Range in Meters : 1 m<sup>3</sup>/hr to 8 m<sup>3</sup>/hr
- Version : Single Phase, 230V & Three Phase 380V-415, 50Hz, A.C. Supply
- Liquid Temperature : 0° C to 90° C and -15° C to 120° C\*
- Ambient Temperature : 45° C
- Max. Working Pressure : 21 bar
- Insulation Class F : "F"
- Degree of Protection : IP 55

\* Applicable only for Special Mechanic Seal Models

**MATERIAL OF CONSTRUCTION**

- |                                  |                                |
|----------------------------------|--------------------------------|
| Pump Shell : SS 304 / SS 316     | Motor Frame : Aluminium        |
| Impeller : SS 304                | Front & Back Cover : Aluminium |
| Diffuser : SS 304                | Cooling Fan Cover : Mild Steel |
| Mech. Seal : SiC vs SiC vs Viton | Cooling Fan : Nylon            |

**DIMENSION**

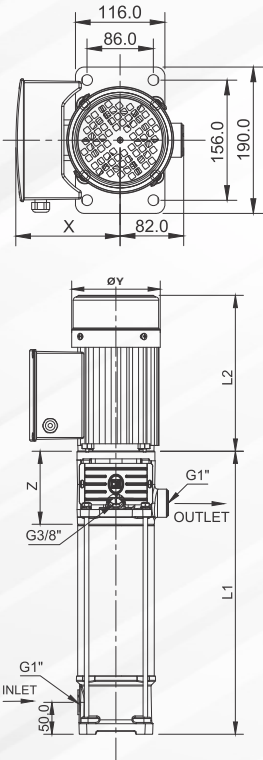

**MTC - 2E**

Model	Power		Dimension in mm							Weight in kg		
	kW	HP	L1	L2		X		ØY	Z	Pump		Motor
				1Ph	3Ph	1Ph	3Ph			MTC	1Ph	3Ph
MTC - 2E/09	1.1	1.5	407.5	260	260	148	112	139	114.5	10.0	10.7	10.4
MTC - 2E/11	1.1	1.5	443.5	260	260	148	112	139	114.5	11.8	10.7	10.4
MTC - 2E/13	1.5	2	497.5	320	290	157	121	160	132.5	12.0	15.3	12.0
MTC - 2E/15	1.5	2	533.5	320	290	157	121	160	132.5	12.7	15.3	12.0
MTC - 2E/18	2.2	3	587.5	303	303	161	125	176	132.5	13.7	18.0	16.7
MTC - 2E/22	2.2	3	695.5	303	303	161	125	176	132.5	15.2	18.0	16.7

**MTC - 4E**

Model	Power		Dimension in mm							Weight in kg		
	kW	HP	L1	L2		X		ØY	Z	Pump		Motor
				1Ph	3Ph	1Ph	3Ph			MTC	1Ph	3Ph
MTC - 4E/12	2.2	3.0	516	303	303	161	125	176	132.5	12.8	18.0	16.7
MTC - 4E/16	3.0	4.0	552	361	361	161	125	176	132.5	14.8	22.2	21.2

**PERFORMANCE CHART**

**MTC - 2E**

MODEL	kW	HP	m <sup>3</sup> /hr	0	1	1.5	2	2.5	3	3.5	4
				0	0.27	0.41	0.55	0.69	0.83	0.97	1.11
MTC-2E/09	1.1	1.5	HEAD IN METRES	86	80	76.5	70	62	52.5	45	37
MTC-2E/11	1.1	1.5		104	85.5	90	83	73.5	62.5	50	37.5
MTC-2E/13	1.5	2		127	117	109	100	87.5	72.5	57.5	42
MTC-2E/15	1.5	2		145	130	122.5	112.5	100	85	67.5	47.5
MTC-2E/18	2.2	3		179	163	153.5	141	126	108	88	63
MTC-2E/22	2.2	3		211	182	180	165	150	127.5	100	70

**MTC - 4E**

MODEL	kW	HP	m <sup>3</sup> /hr	0	2	3	4	5	6	7	8
				0	0.55	0.83	1.11	1.38	1.66	1.94	2.22
MTC-4E/12	2.2	3	HEAD IN METRES	110	105	95	90	82	70	55	40
MTC-4E/16	3	4		160	147	140	132.5	122	104	80	55

**PERFORMANCE CURVE**

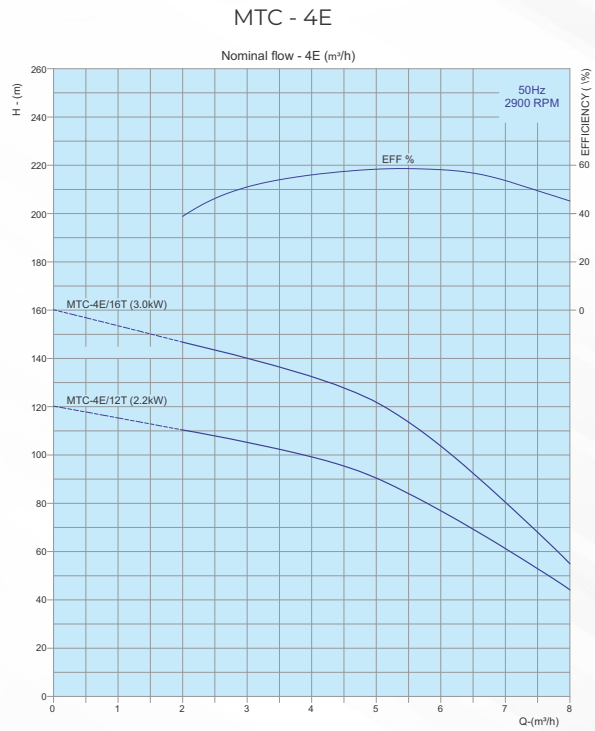
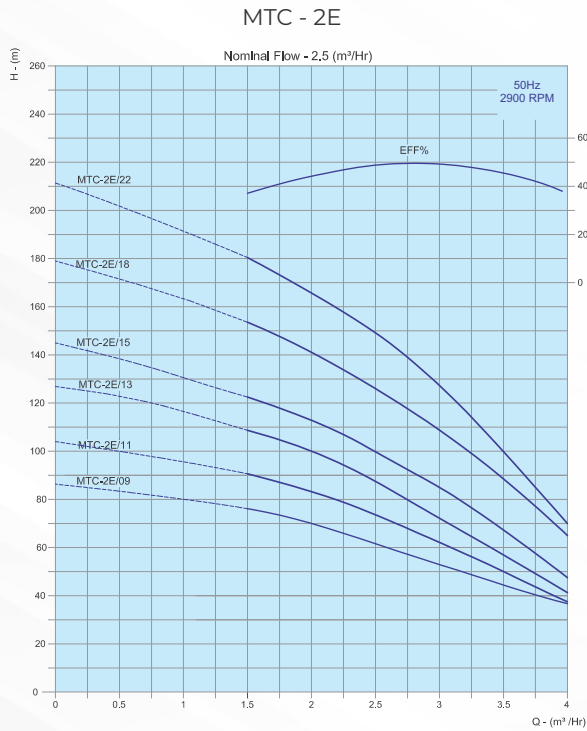

**MVC SERIES**



**SPECIFICATIONS**

- Power Range : 1.1 kW to 3 kW (1.5 HP to 4 HP)
- Head Range in Meters : 37 Mtrs to 211 Mtrs
- Flow Range in Meters : 1 m<sup>3</sup>/hr to 8 m<sup>3</sup>/hr
- Version : Single Phase, 230V & Three Phase 380V-415, 50Hz, A.C. Supply
- Liquid Temperature : 0° C to 90° C and -15° C to 120° C\*
- Ambient Temperature : 45° C
- Max. Working Pressure : 21 bar
- Insulation Class F : "F"
- Degree of Protection : IP 55

\* Applicable only for Special Mechanic Seal Models

**MATERIAL OF CONSTRUCTION**

- Outer Shell : SS 304
- Pump Head & Base : CI
- Impeller & Diffuser : SS 304
- Pump Shaft : SS 304 / SS 431
- Bearing Ring : SiC & T.C
- Mechanical Seal : SiC Vs SiC Vs Viton / T.C Vs Car Vs Viton
- Motor Frame : Aluminium
- Front & Back Cover : Aluminium
- Cooling Fan Cover : Mild Steel
- Cooling Fan : Nylon

**DIMENSION**

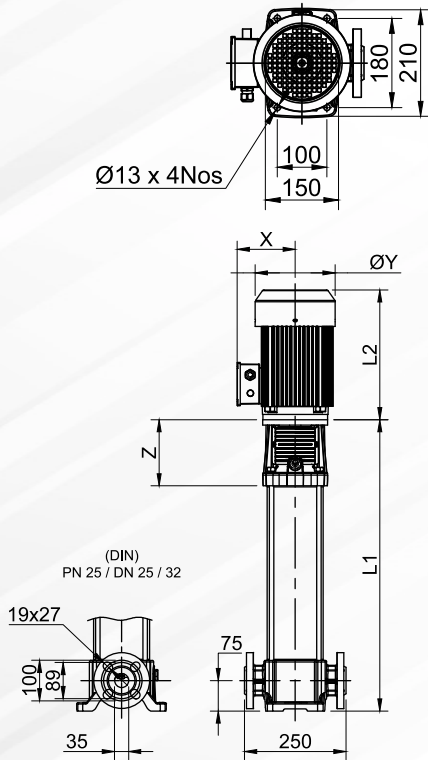

Model	Power		Dimension in mm (Approx)					Weight in kg	
	kW	HP	L1	L2	X	ØY	Z	Pump	Motor
				1Ph	1Ph			MVC	1Ph
MVC-02/09	1.1	1.5	395	260	148	139	146	23.6	10.7
MVC-02/11	1.1	1.5	431	260	148	139	146	25.0	10.7
MVC-02/13	1.5	2	485	320	157	160	163	26.6	15.3
MVC-02/15	1.5	2	521	320	157	160	163	28.0	15.3
MVC-02/18	2.2	3	575	303	161	176	163	30.1	18.0
MVC-02/22	2.2	3	647	303	161	176	163	33.0	18.0
MVC-04/12	2.2	3	575	303	161	176	163	29.4	18.0
MVC-4E/12	2.2	3	466	303	161	176	163	25.9	18.0
MVC-4E/16	3	4	538	361	161	176	163	28.7	22.2

**PERFORMANCE CHART**

MODEL	kW	HP	m³/hr	0	1.5	2	2.5	3	3.5	4
				0	0.41	0.55	0.69	0.83	0.97	1.11
MVC-02/09	1.1	1.5	HEAD IN METRES	86	76.5	70	62	52.5	45	37
MVC-02/11	1.1	1.5		104	90	83	73.5	62.5	50	37.5
MVC-02/13	1.5	2.0		128	109	100	87.5	72.5	57.5	42
MVC-02/15	1.5	2.0		145	122.5	112.5	100	85	67.5	47.5
MVC-02/18	2.2	3.0		179	153.5	141	126	108	88	63
MVC-02/22	2.2	3.0		211	180	165	150	127.5	100	70

MODEL	kW	HP	m³/hr	0	2	3	4	5	6	7	8
				0	0.55	0.83	1.11	1.38	1.66	1.94	2.22
MVC-04/12	2.2	3.0	HEAD IN METRES	120.5	110	105	99.5	90	77	61	44.5
MVC-4E/12	2.2	3.0		110	105	95	90	82	70	55	40
MVC-4E/16	3.0	4.0		160	147	140	132.5	122	104	80	55

**PERFORMANCE CURVE**

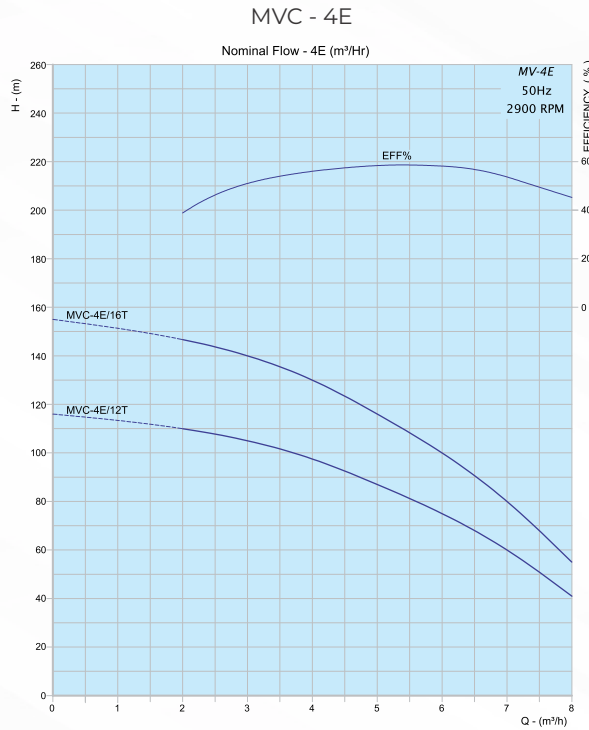
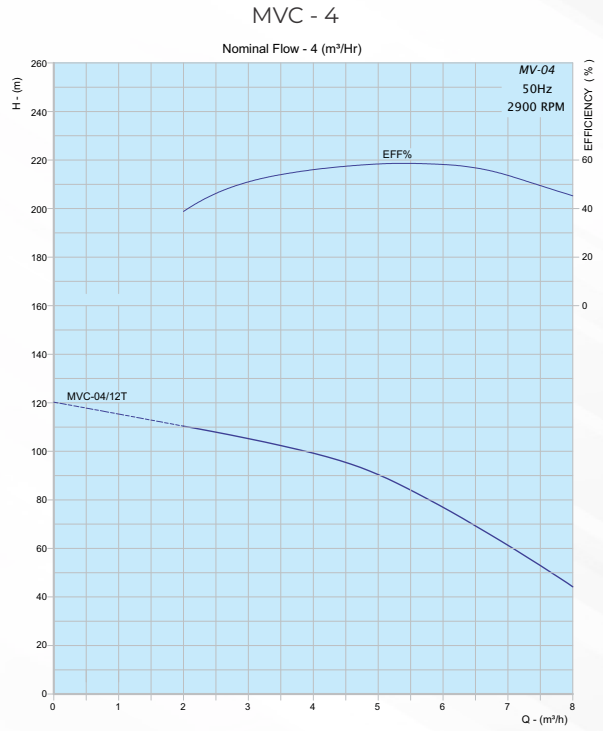
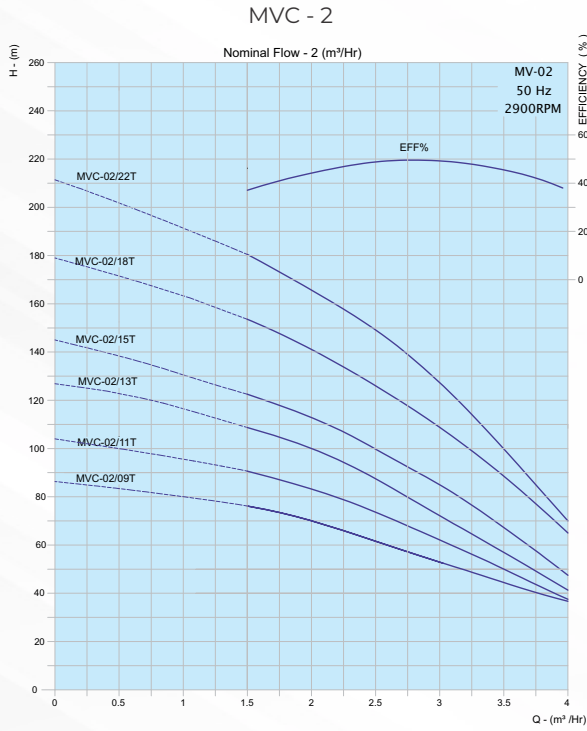

**TOLL FREE 1800 121 1243** [www.crigroups.com](http://www.crigroups.com)

[www.facebook.com/cripumps](http://www.facebook.com/cripumps) [www.twitter.com/cri\\_pumps](http://www.twitter.com/cri_pumps)